

Fax Cover This is a confidential message, intended solely for the person to whom it is addressed. If you receive this message in error, please forward it to the correct person, or mail it back to us. Thank you.

To Miguel Gomez
Fax No. (419) 784-4760
From Adam C. Hoff, P.E. - City Engineer *ACH*
Date 9/9/99
Subject 1059 Scott Street Sanitary Service Connection
Pages 2, including this one

Per our previous telephone conversation, while performing investigation and repair to a City sewer located behind your property at 1059 Scott Street, it was found that a blockage exists in the four (4) inch vitrified clay service connection leading to the City's sewer. As near as we can tell, a major blockage or collapsed tile exists roughly six (6) feet from the existing sanitary clean out. From our experience with vitrified clay service connections and the amount of trees along the route to the City's sewer, it is likely that roots have also intruded into the service connection creating additional, smaller obstructions.

When performing our necessary repairs, the City replaced a short segment of your service connection immediately adjacent to the City's sewer. However, we are confident that additional segments will need to be replaced and/or augered out to allow flows from the residence to discharge to the City sewer. If these obstructions are not addressed, we believe that the sewage will discharge out of the existing clean out onto the lawn and, ultimately, into the Oberhaus Creek creating obvious health concerns. Therefore, it is our recommendation that the service connection be repaired as soon as possible. The following is a sketch showing the approximate locations of each of the above described items.

If you have any questions or require additional information, please call me at (419) 592-4010. Thank you.

c: Jon Bisher, Rex Moll, Jeff Marihugh, Brent Damman

255 W. Riverview Ave.
Napoleon, Ohio 43545

(419) 592-4010 Phone
(419) 599-8393 Fax

Scott Street



50 SHEETS
22-141
100 SHEETS
22-142
200 SHEETS
22-144

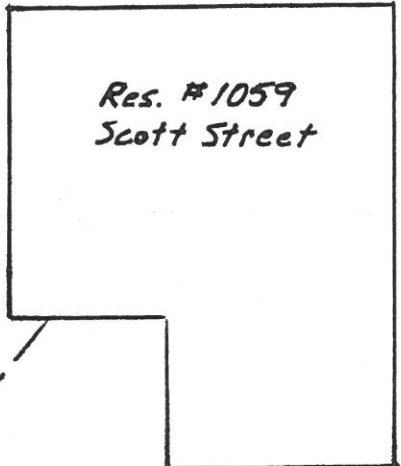

Res. #1059
Scott Street

Oberhaus Creek

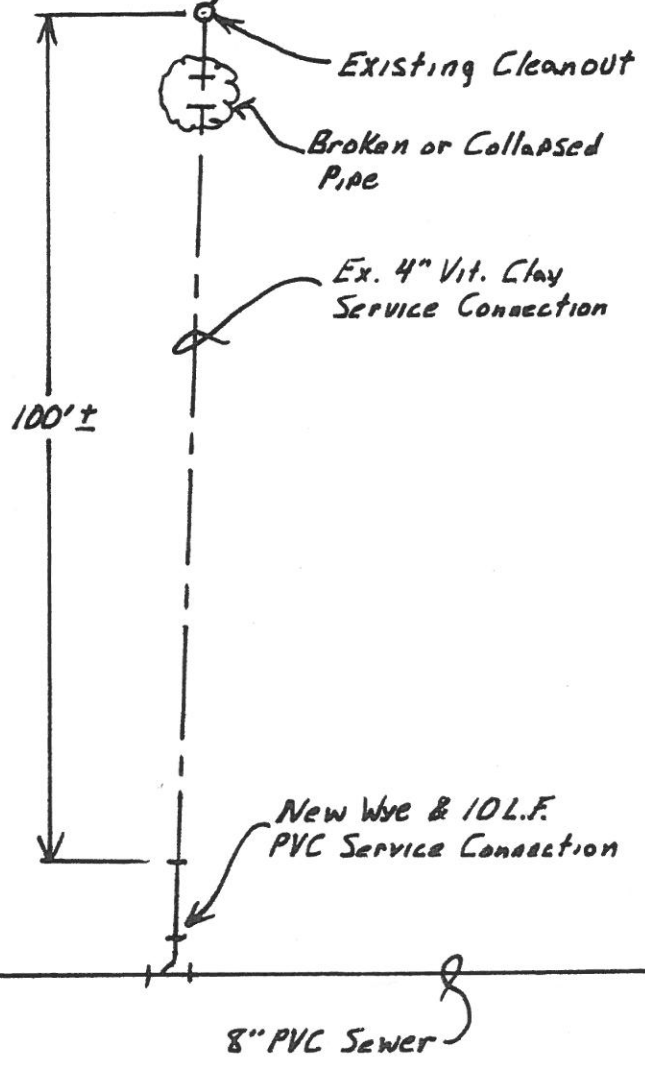

Existing Cleanout

Broken or Collapsed
Pipe

Ex. 4" Vit. Clay
Service Connection

100' ±

New Wye & 10L.F.
PVC Service Connection

8" PVC Sewer